

THIS DRAWING IS TO BE READ IN CONJUNCTION WITH ALL RELEVANT SPECIFICATIONS AND DRAWINGS ISSUED. THIS DRAWING IS CORRECT AT TIME OF SURVEY

© COPYRIGHT FIRNTEC LTD 2022

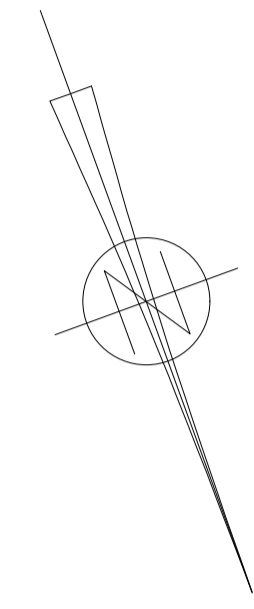

BIRCH TREE COURT LEVEL 4

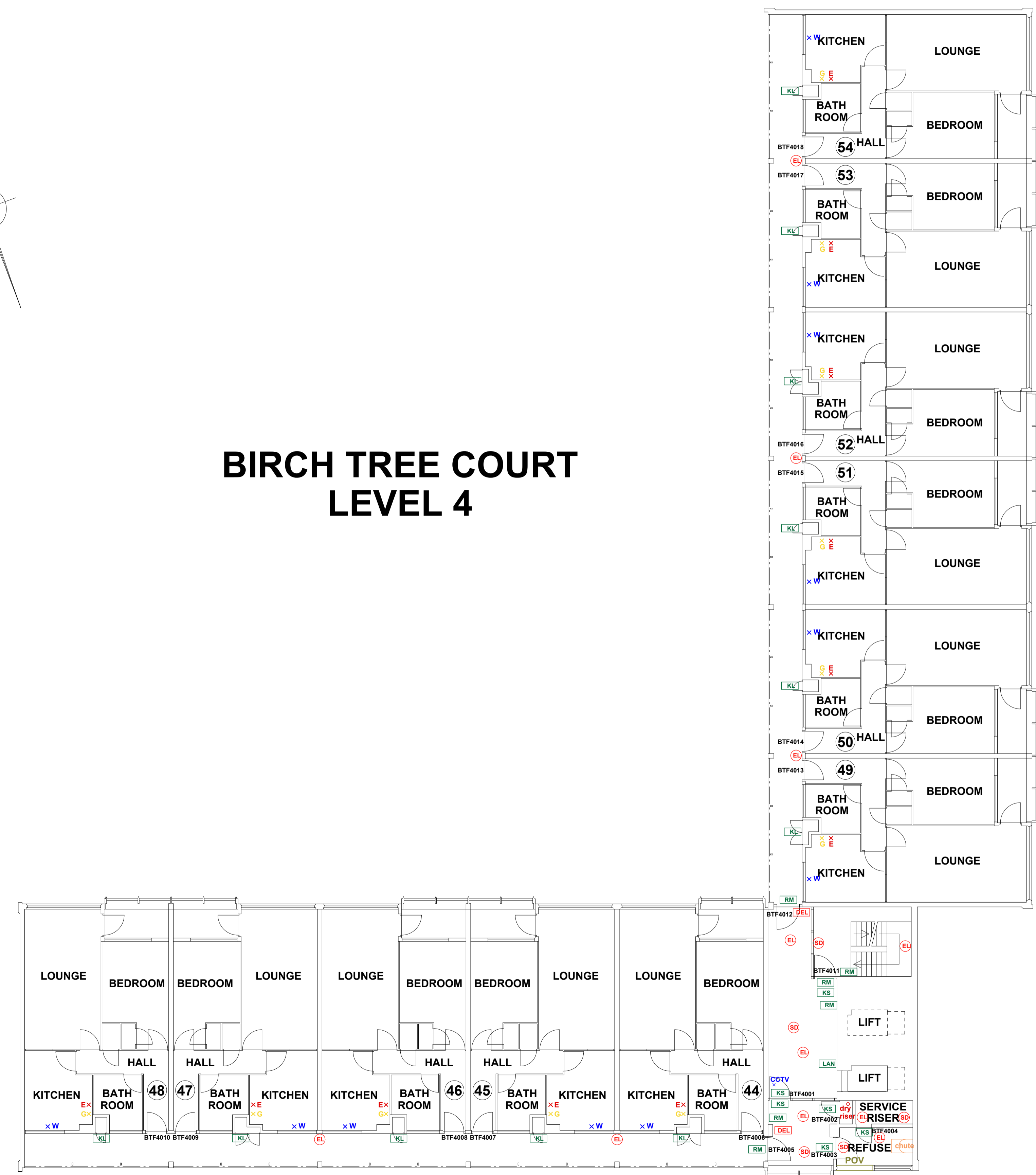

- FIRE PRECAUTIONS LEGEND**
- ⊙ Break glass type fire alarm call point
 - ⊕ Heat sensitive detectors
 - ⊕ Smoke sensitive detectors
 - ⊕ Emergency light point.
 - ⊕ Firemans Switch
 - ⊕ Emergency Drop Key Access
 - ⊕ Fire alarm indicator / repeat panel
 - ⊕ Door/Access fitted with Gerda D1 Key lock
 - ⊕ Door/Access fitted with FB1 Key lock
 - ⊕ Door/Access fitted with FB2 Key lock
 - ⊕ Door/Access fitted with FB4 Key lock
 - ⊕ Door/Access fitted with FB11 Padlock
 - ⊕ Door/Access fitted with FB14 Padlock
 - ⊕ Dry Riser Outlet
 - ⊕ Digital electronic lock door entry/exit system
 - ⊕ Premises Information Box
 - ⊕ Permanently Open Vent
 - ⊕ Automatic Opening Vent
 - ⊕ Openable Vent
 - ⊕ Fire alarm sounder ('X' indicates integral flashing - Xenon light)
 - ⊕ CCTV Security Camera
 - ⊕ Fire Brigade Key Access
- EXTINGUISH**
- ⊕ 1.1m x 1.1m fire blanket - base of container to be 1500mm above floor level
 - ⊕ 6 litres AFFF aqueous foam extinguisher to BS:6575
 - ⊕ 9 litre wet chemical type extinguisher
 - ⊕ 4.5 litre dry powder type extinguisher
 - ⊕ 2 kg carbon dioxide type extinguisher
 - ⊕ 4.5 kg carbon dioxide type extinguisher
 - ⊕ 9 kg water type extinguisher
 - ⊕ 6 litre water type extinguisher
- FIRE EXIT SIGNAGE**
- ⊕ 'E' Signs to be externally illuminated by adjacent emergency light point
 - ⊕ 'FE' denotes as previous but illuminated as part of sign
 - ⊕ 'RM' denotes non illuminated sign
- FIRE DOOR SIGNS AND FIRE ACTION NOTICES**
- ⊕ Fire Action Notice
 - ⊕ Emergency Floor Plan
 - ⊕ "FIRE DOOR KEEP SHUT" sign
 - ⊕ "FIRE DOOR KEEP LOCKED" sign
 - ⊕ "AUTOMATIC FIRE DOOR KEEP CLEAR" or "FIRE EXIT KEEP CLEAR" sign
 - ⊕ "CAUTION, IN THE EVENT OF FIRE DO NOT USE THIS LIFT"
 - ⊕ DISTRIBUTION BOARD



REV	DATE	AMENDMENTS

WEB: WWW.FIRNTEC.COM
 EMAIL: CONTACTUS@FIRNTEC.COM
 ADDRESS: 1ST FLOOR, ENDEAVOUR HOUSE, PARKWAY CT, PLYMOUTH PL6 8LK
 TEL: 01752 977 147

PROJECT: BIRCH TREE COURT
 ADDRESS: BIRCH TREE COURT
 WYTHENSHAW
 MANCHESTER
 M22 3RY
 DWG NO.: BTC_220020L05
 DWG TITLE: LEVEL 4
 DWG DATE: NOVEMBER 2022
 DWG SIZE: SCALE 1:100 @ A1
 DRAWN: NR | CHECKED: BR | ISSU: