

THIS DRAWING IS TO BE READ IN CONJUNCTION WITH ALL RELEVANT SPECIFICATIONS AND DRAWINGS ISSUED. THIS DRAWING IS CORRECT AT TIME OF SURVEY

© COPYRIGHT FIRNTEC LTD 2022

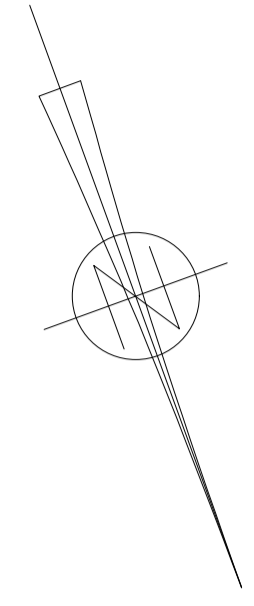

BIRCH TREE COURT LEVEL 0

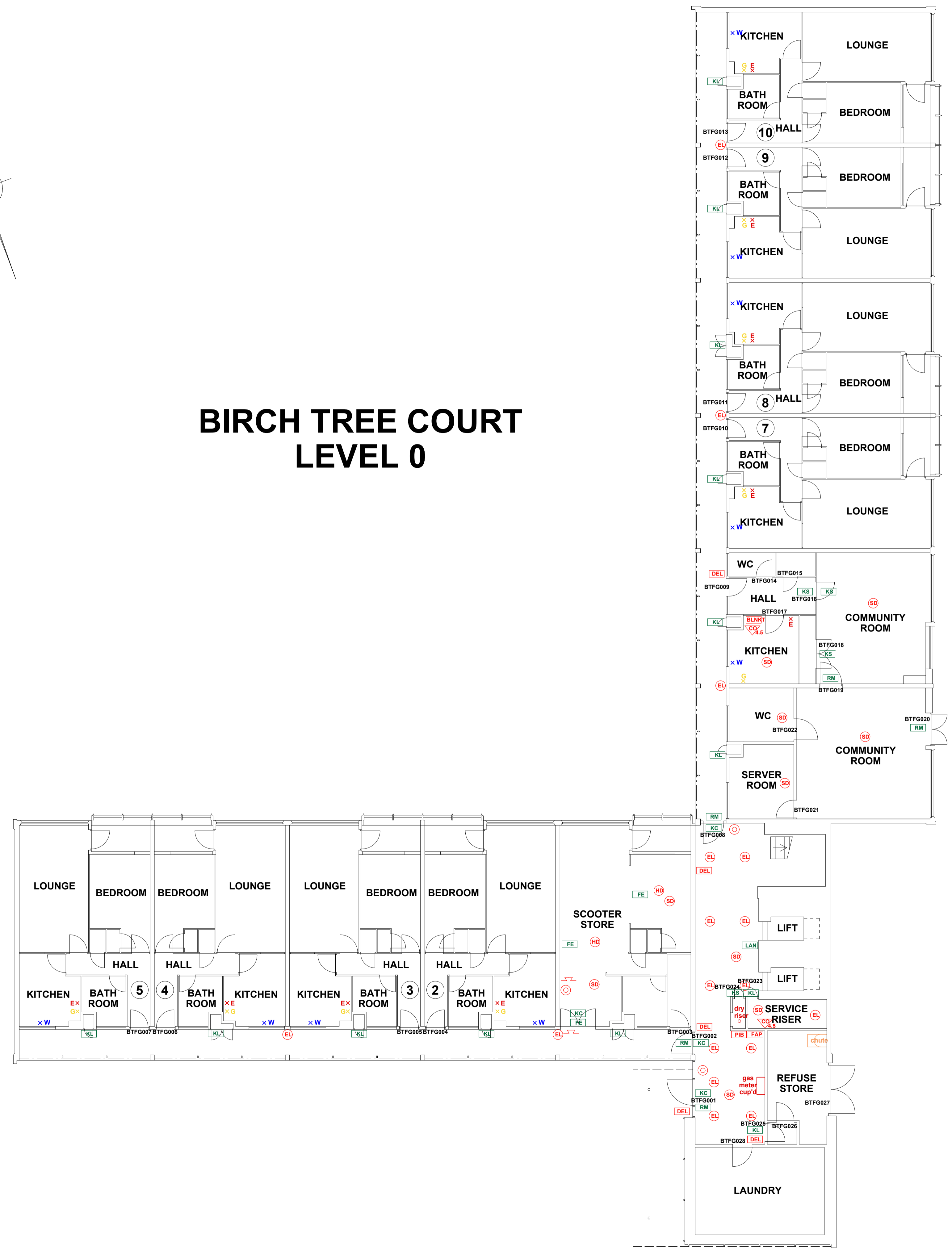

- FIRE PRECAUTIONS LEGEND**
- ⊙ Break glass type fire alarm call point
 - HD Heat sensitive detectors
 - SD Smoke sensitive detectors
 - EL Emergency light point.
 - FS Firemans Switch
 - DKA Emergency Drop Key Access
 - FAP Fire alarm indicator / repeat panel
 - GD1 Door/Access fitted with Gerda D1 Key lock
 - FB1 Door/Access fitted with FB1 Key lock
 - FB2 Door/Access fitted with FB2 Key lock
 - FB4 Door/Access fitted with FB4 Key lock
 - FB11P Door/Access fitted with FB11 Padlock
 - FB14P Door/Access fitted with FB14 Padlock
 - DRO Dry Riser Outlet
 - DEL Digital electronic lock door entry/exit system
 - PIB Premises Information Box
 - POV Permanently Open Vent
 - AOV Automatic Opening Vent
 - OV Openable Vent
 - X- Fire alarm sounder ('X' indicates integral flashing - Xenon light)
 - CCTV CCTV Security Camera
 - FB Fire Brigade Key Access
- EXTINGUISH**
- BLNRT 1.1m x 1.1m fire blanket - base of container to be 1500mm above floor level
 - AF 6 litres AFFF aqueous foam extinguisher to BS:6575
 - DP 9 litre wet chemical type extinguisher
 - CO 4.5 litre dry powder type extinguisher
 - CO 2 kg carbon dioxide type extinguisher
 - CO 4.5 kg carbon dioxide type extinguisher
 - W 9 kg water type extinguisher
 - W 6 litre water type extinguisher
- FIRE EXIT SIGNAGE**
- E 'E' Signs to be externally illuminated by adjacent emergency light point
 - FE 'FE' denotes as previous but illuminated as part of sign
 - RM 'RM' denotes non illuminated sign
- FIRE DOOR SIGNS AND FIRE ACTION NOTICES**
- FAN Fire Action Notice
 - EFP Emergency Floor Plan
 - KS "FIRE DOOR KEEP SHUT" sign
 - KL "FIRE DOOR KEEP LOCKED" sign
 - KC "AUTOMATIC FIRE DOOR KEEP CLEAR" or "FIRE EXIT KEEP CLEAR" sign
 - LAN "CAUTION, IN THE EVENT OF FIRE DO NOT USE THIS LIFT"
 - DB DISTRIBUTION BOARD

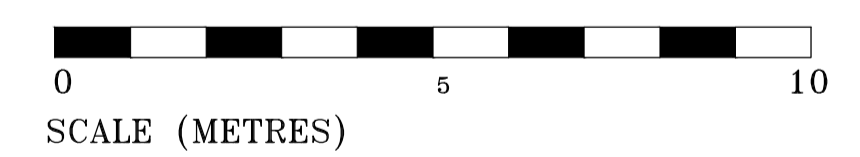

REV	DATE	AMENDMENTS

WEB: WWW.FIRNTEC.COM
 EMAIL: CONTACTUS@FIRNTEC.COM
 ADDRESS: 1ST FLOOR, ENDEAVOUR HOUSE, PARKWAY CT, PLYMOUTH PL6 8LR
 TEL: 01752 977 147

PROJECT: **BIRCH TREE COURT**
 ADDRESS: BIRCH TREE COURT
 WYTHENSHAW
 MANCHESTER
 M22 3RY
 DWG NO.: BTC_220020L01
 DWG TITLE: LEVEL 0
 DWG DATE: NOVEMBER 2022
 DWG SIZE: SCALE 1:100 @ A1
 DRAWN: NR | CHECKED: BR | ISSU